

All New A-series Wire Cut

Innovation Achievement Future

Advanced compact design

Saving space nearly 15% compared to conventional model.

Advanced rigidity and thermal balanced structure

The machine has been designed at gantry type base frame through 3D simulate designing and FEA optimize process. With optimum structure and reinforced ribs to secure the perfectly rigidity and highly accurate machining.



LINEAR MOTOR

Beyond the limit of technology. The in house "Linear Motor Technology" developed by CHMER Group has overcome the mechanical inaccuracy associated with the back-lash that came from ball-screw drive system, the actual position is precisely monitored.



Unique slanted wire ejection mechanism that gets rid of the possibility of water leakage and friction comes from the lower arm that interfere Y axis movement so as to machining accuracy.

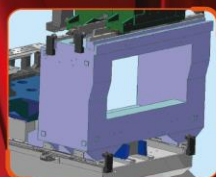

Worldwide AA+ grade gantry column design to conduct a high rigidity and finest thermal balance on the casting.



To comply with the trend of environment protection, the first energy saving circuit for EDM in Taiwan that applies "counter electric potential" elevates the voltage, achieves 15% power consumption reduction that cuts down on the operation cost of customer and the affection to the environment.



5th Generation AWT system

In house new generation Auto Wire Threading (AWT) features concise mechanism and is capable of threading on location (wire break point) and in water. "Wire Tension Control Technology" for highest reliability.



Specifications

Model	A422SL
Axis Travel(X*Y*Z)	400*250*200
Auxiliary Table Travel(U*V)	60*60
Max. Size of Workpiece	800x560x195
Max. Weight of Workpiece	550
X Y Feed Rate	Max. 1500 mm/min
Axis Drive System	X,Y axis by linear Motor, U,V,Z axis by AC Servo Motor
Wire Diameter Range(Standard)	Ø0.15-0.3mm (ø0.25mm)
Max. Wire Feed Rate	300mm/sec
Wire Tension	300-2500gf
Taper Angle	±14.5°/80mm WIDE ANGLE NOZZLE
Machine Weight	Kg 2600
Working Fluid Supply Unit	
Tank Capacity	580L
Filter Element	Paper
Ion Exchange Resins	14L
Conductivity Control	Auto
Fluid Temperature Control	Auto
Power Supply Unit	
Circuit System	Power MOS Transistor
Max. Output Current	25A
IP Select	10
Off Time System	50
CNC Unit	
Data Input	Keyboard,RS-232C
Display	15-Inch Color
Control System	32bit,1-CPU,Semi-Closed Loop
Control Axis	X,Y,U,V,Z (5 Axis)
Setting Unit	0.001mm
Max. Command Value	±9999.999mm
Interpolation	Linear/Circular
Command System	ABS/INC
Machining Feed Control	Servo/Const. Feed
Scaling	0.001-9999.999
Machining EDM Condition Memory	1000-9999
Total AC Power Input	3 Phase 220 ±10%/13kva



WIRE FEEDER UNIT

Wire Feeder can supply wire continuously for over extended periods (About 150HR at 30 KG loading of wire electrode)

Standard Accessories

1. X,Y axis Linear Motor 1set
2. Linear scale 1set
3. AWT
4. Auto Vertical Alignment jig 1 set
5. Chiller 1set

Optional

1. Ø 0.1 mm wire unit
2. AC-µ Circuit
3. Wire feeder unit
4. Wire Chopper
5. Bridge Rule
6. B-Axis (6th Axis Function)

Machine Layout

A422SL

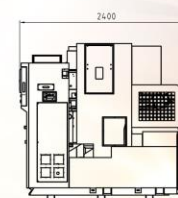
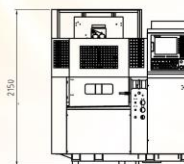

CHING HUNG MACHINERY & ELECTRIC INDUSTRIAL CO., LTD.

No.3, Jing-Ke 1st Road, Nantun District, Taichung City 408, Taiwan
TEL:+886 4-23509188 FAX:+886 4-23500977
http://www.chmer.com Email:overseas@mail.chmer.com

Agent / Distributor